

TANK ACCESSORIES

ELECTRIC SCREW-IN HEATING ELEMENT



EEH Electric screw-in heating element

Electrical heating element for enamelled boiler and tank, with 6/4" male thread and 132 mm unheated zone starting with the sealing area.

Heating elements made of high-corrosion-resistant chrome-nickel steel 2.4858 (AISI B424) suitable for up to 10 bar operating pressure and for use in containers with up to 100 mm insulation. The extension sleeve required for this purpose is available as an accessory (reduction from 2", Item. No. 1610609).

The ambient temperature at the housing must not exceed 80°C. Protection class IP 44 Externally-located temperature control unit (approx. 30 to 75°C) with frost-protection function and integrated excess temperature protection (98°C-6K) incl. RESET function.

The electrical connection is by means of screw terminals. Connected voltage 400 V, 3/N/PE, 50/60 Hz or 230 V, 1/N/PE, 50/60 Hz.

Notes:

- According to the standards (DIN EN 60335, VDE 0700-73 and VDE 0700-253), scald protection (= domestic hot water mixing valve) is compulsory for installation of an electrical immersion heater with a temperature control range above 60 °C!
- A circuit breaker with 3 mm contact opening or a line safety switch must be provided in the electrical supply line to the electric screw-in heating element!

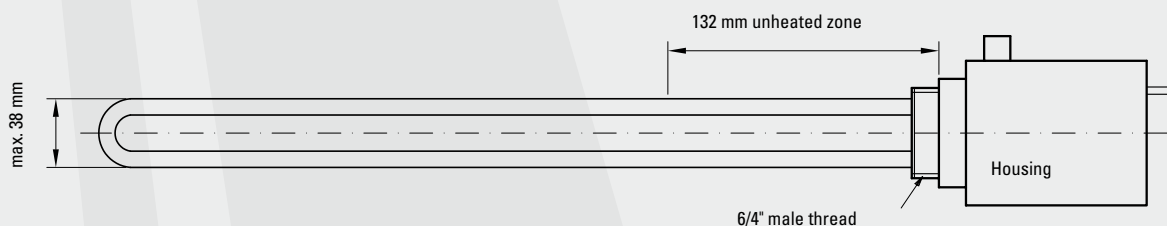

Specifications

Type	EEH 2000	EEH 2500	EEH 3000	EEH 3750	EEH 4500	EEH 6000	EEH 9000
Item no.	1610468	1610469	1610470	1610471	1610472	1610473	1610474
Power	2 kW	2.5 kW	3 kW	3.75 kW	4.5 kW	6 kW	9 kW
Voltage	230 V	230 V	230 V	400 V	400 V	400 V	400 V
Installation depth	320 mm	390 mm	390 mm	390 mm	470 mm	470 mm	690 mm

EXTENSION SLEEVE FOR EEH

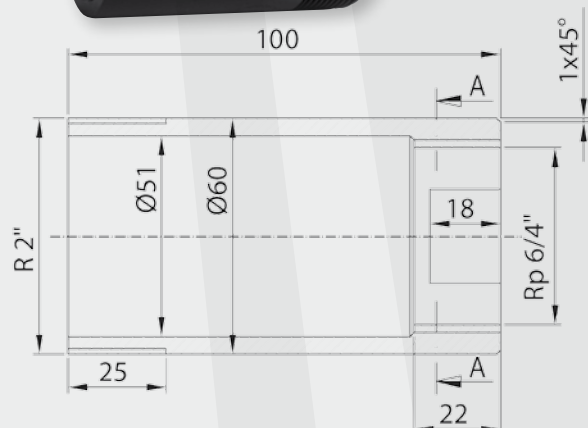

VM extension sleeve

for EEH electric screw-in heating element

For installation of an electric screw-in heating element in a Pro-Clean®, Pro-Heat or FS tank. EPD-coated.

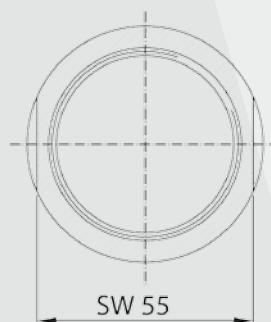

Specifications

Type	VM
Item no.	1610609
Material	S 235 JR
Extends by	80 mm
Design	EPD-coated
Spanner size	55